

Part Number: AE-RJD102A012H-30

1*1 Port RJ45 10/100Base-T Network Connector

- RoHS compliant.
- Housing: PA66 Black UL94V-0.
- Shielding: Thickness With Brass.
- Contact: Phosphor bronze. With 30μ" gold plating.
- Operating Temperature: -40°C TO +85°C.

Mechanicals:

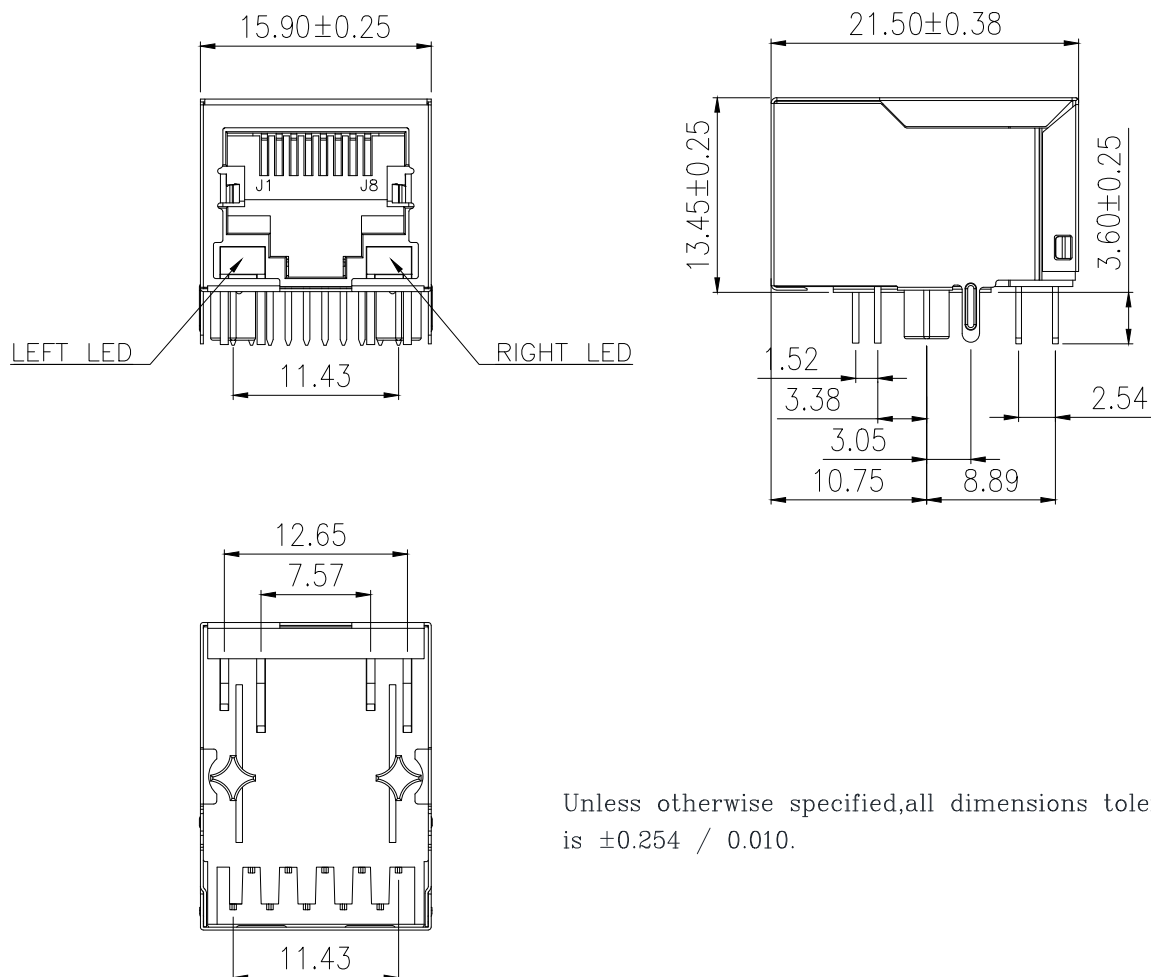

Unless otherwise specified, all dimensions tolerances is $\pm 0.254 / 0.010$.

Part Number: AE-RJD102A012H-30

1*1 Port RJ45 10/100Base-T Network Connector

Schematic

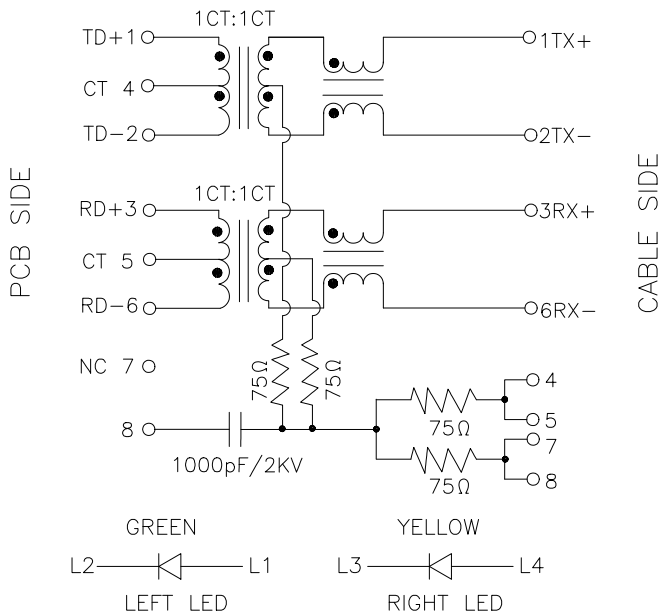

Electrical Characteristics:

1. TR: (100KHz, 0.1V);
PINS: (P1-P2): (J1-J2) = 1:1 ± 5%
PINS: (P3-P6): (J3-J6) = 1:1 ± 5%
2. LX: (100KHz, 100mV, 8mA, DC Bias)
PINS: (P1, P2), (P3, P6) = 350uH MINIMUM
3. INSERTION LOSS:
- 1.0dB MAXIMUM AT 0.3MHz TO 100MHz;
4. RETURN LOSS:
- 18dB MINIMUM AT 1MHz TO 30MHz;
- 15dB MINIMUM AT 30MHz TO 60MHz
- 12dB MINIMUM AT 60MHz TO 80MHz
5. CROSS TALK:
- 30dB MINIMUM AT 1MHz TO 100MHz
6. COMMON TO COMMON MODE REJECTION:
- 30dB MINIMUM AT 1MHz TO 100MHz
7. HI-POT:
PINS (P4, P5) TO (J1, J3, J4, J7) = 2250VDC;

Recommended PCB Layout:

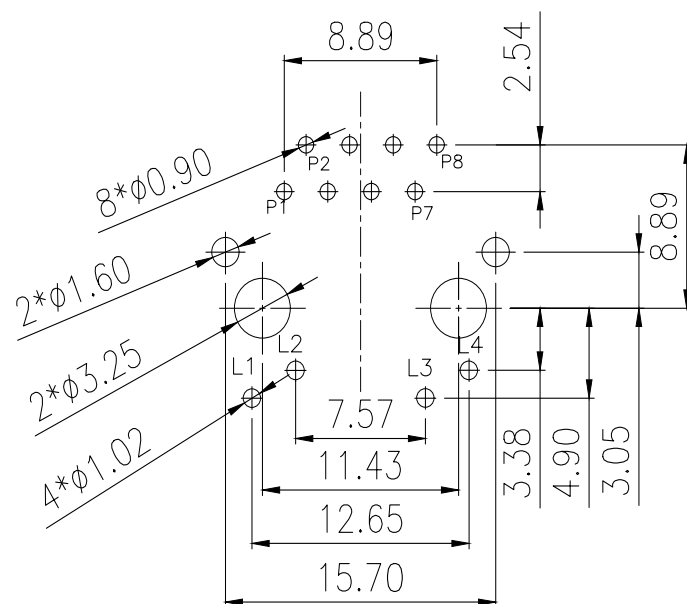

RECOMMENDED P.C.B LAYOUT (PCB THICKNESS: 1.6mm)
COMPONENT SIDE VIEW (TOLERANCE: ±0.05mm)

Part Number: AE-RJD102A012H-30

1*1 Port RJ45 10/100Base-T Network Connector

Page: 3/3

Reliability Test And Condition:

Test Item	Test Condition	Cycles or Hours	Reference
Vibration Test	1. Amplitude: 0.75mm 2. Frequency: 5-500Hz 3. Number of sweep cycles per axis 10 4. Direction: X. Y. Z	Duration: 2 hours each direction	IEC-68-2-6
Drop Test	1. Height: 1m 2. Concrete platform	6 Times	IEC-68-2-32
Thermal Shock Test	1. Low temperature: -40℃ 2. High temperature: + 85℃ 3. Soak time: 30 minutes 4. Transition time: less than 20 minutes	5 Cycles	IEC-68-2-14
Solderability Test	Dipped in 245±5 ℃ molten solder	Time: 3~5 seconds	IEC-68-2-20
High Temperature Test	1. Humidity: less than 50% RH 2. Temperature: 85±2 ℃	Duration: 96 hours	IEC-68-2-2
Low Temperature Test	Temperature: -40±3 ℃	Duration: 96 hours	IEC-68-2-1